

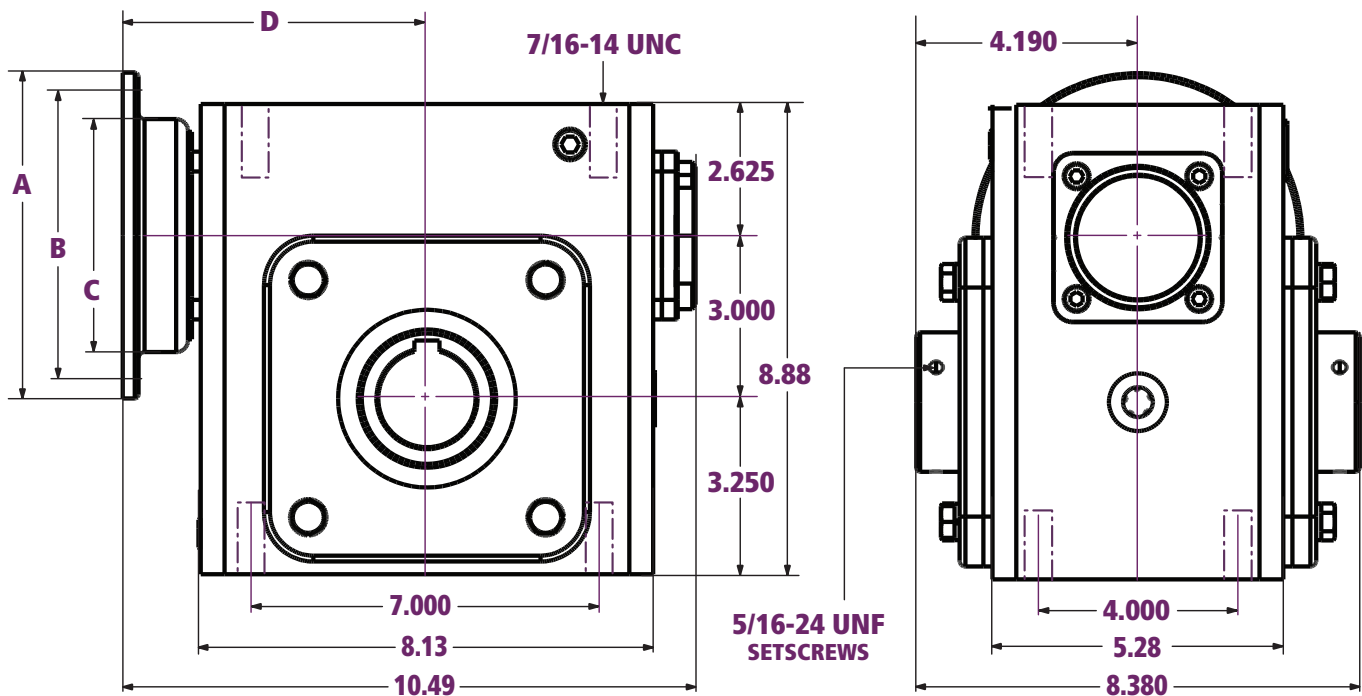

XH300 Dimensions

All dimensions listed in inches



Motor Options & Dimensions (in)

NEMA Frame	Motor Shaft Dia. (in)	A	B	C	D
		OD Flange	Bolt Circle	Pilot Bore	Flange Depth
56C	0.625	6.50	5.88	4.5	5.60
140TC	0.875		5.88	4.5	5.60
180TC	1.125		7.25	8.5	6.78

Output Bushing Kits

Output Bushing Diameter (in)
1
1-1/8
1-3/16
1-1/4
1-3/8

Output Hollow Bore

Output Keyway (in)	Output Bore (in)
3/8 x 3/16	1.4375

Ratios

Nominal Ratios	Exact Ratios
5:1	4.8:1
10:1	10.3:1
15:1	15.5:1
20:1	20.5:1
30:1	30.0:1
40:1	40.0:1
50:1	50.0:1
60:1	60.0:1

Efficiency

Nominal Ratios	Efficiency (%)
5:1	≈ 93
10:1	≈ 87
15:1	≈ 84
20:1	≈ 81
30:1	≈ 73
40:1	≈ 69
50:1	≈ 64
60:1	≈ 63

Specifications

Center Distance (in)	Weight (lbs)	Est. Oil Fill Amount* (oz)
3.000	66.0 [74.8 [†]]	51.7

*For Position 1.

[†]Approximate weight for gearbox with NEMA frame 180TC.

XH300 Accessories

and X300 Base Kit Dimensions

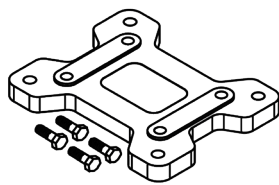
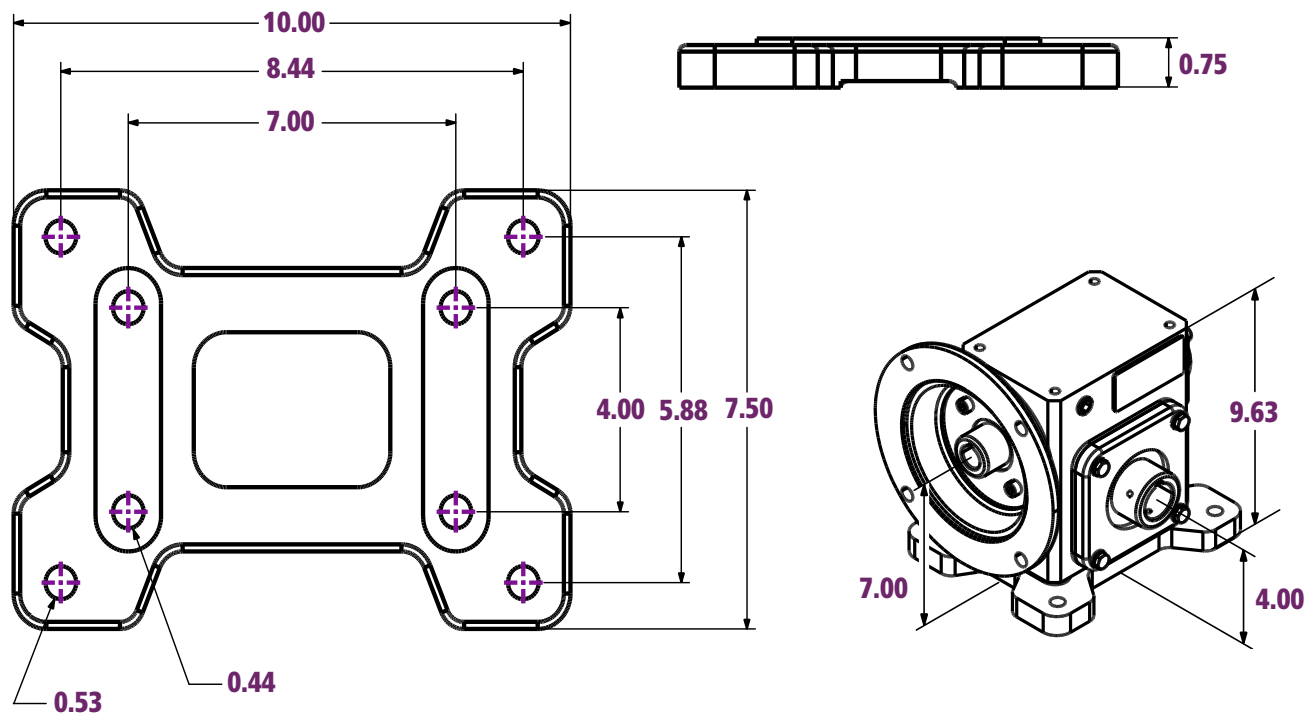

Foot Mounted Base Kit

XBK300

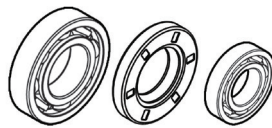

Component Repair Kit

XHRK300

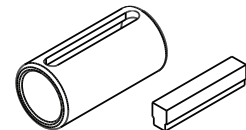

Input Quill Adapter Option

X143-56

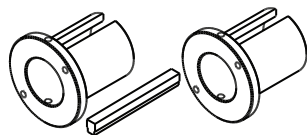

Output Bushing Kits*

VH300
(See other page for bore sizes)

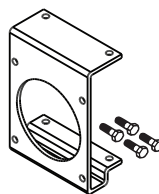

Output Bracket Kit*

XOB300

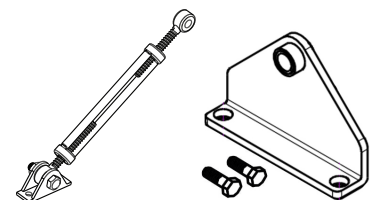

Torque Arm Kit*

XTA300

*Made to order.